

SPECIFICATIONS : ISS - ISOTECH SEISMIC SNUBBER

Model	MAX LATERAL LOAD ALLOWED-WITHOUT NEOPRENE PADS UNDER SNUBBER		MAX LATERAL LOAD ALLOWED-WITH NEOPRENE PADS UNDER SNUBBER		APPROXIMATE WEIGHT	
	lbf.	kN	lbf.	kN	lbs.	kg
ISS-1200-2500	2790	1265	2525	1145	14	6.4

ISS-1200-2500

3/8" THK DOUBLE RIBBED NEOPRENE PAD

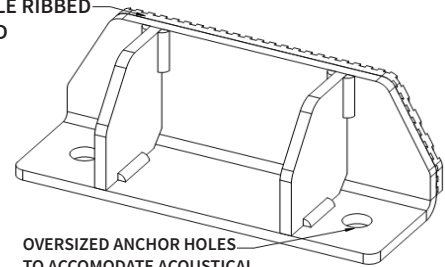

OVERSIZED ANCHOR HOLES TO ACCOMMODATE ACOUSTICAL GROMMETS

Dimension : ISS ISOTECH SEISMIC SNUBBER

Model	L1		W		H		R		A	
	in	mm	in	mm	in	mm	in	mm	in	mm
ISS-1200-2500	9	229	4 1/4	108	4 3/8	118	3/8	16	1 1/2	39
	L2		W1		B		ØD			
	12	305	3/8	10	1 3/4	45	7/8	23		

ISOLATOR'S LOCATIONS

1:	5:
2:	6:
3:	7:
4:	8:

3/8" THK DOUBLE RIBBED NEOPRENE PAD

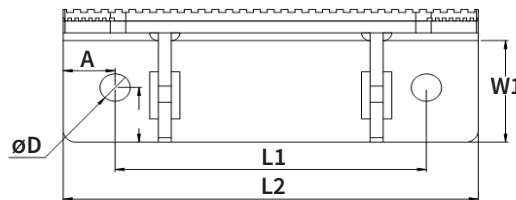

OVERSIZED ANCHOR HOLES TO ACCOMMODATE ACOUSTICAL GROMMETS

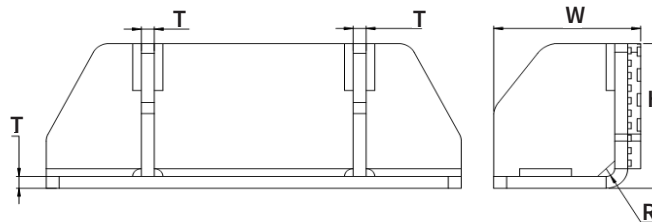
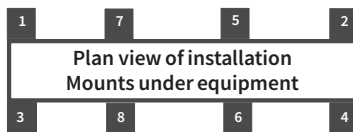
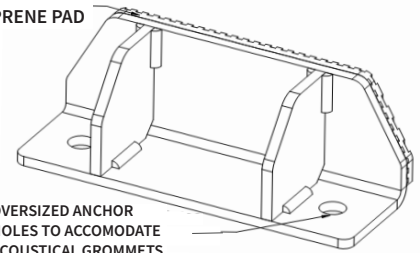

Notes:

- Seismic snubbers are made of high yield/strength steel material and are designed for 1 g lateral force
- Seismic snubbers have powder-coat finish to provide maximum corrosion resistance
- Seismic Load calculation must be performed to ensure proper selection of product. Anchor type, embedement, edge distance and anchor size have direct effect on snubber capacity

PROJECT INFORMATION		EQUIPMENT INFORMATION		Canada location	USA Location
Customer:		Type:		35 Silton Road Woodbridge ON L4L 7Z8 CANADA T: 905-856-5001	3021 E Coronado St. Anaheim, CA.,92806 U.S.A T: 949-788-2930
Project:		Qty Required:			
Drawing No:		Operating Weight:			
Notes:				Tool free : 1-888-831-3311 www.isotechindustries.com	

