

SPECIFICATIONS : ISS - ISOTECH SEISMIC SNUBBER

Model	MAX LATERAL LOAD ALLOWED-WITHOUT NEOPRENE PADS UNDER SNUBBER		MAX LATERAL LOAD ALLOWED-WITH NEOPRENE PADS UNDER SNUBBER		APPROXIMATE WEIGHT	
	Lbf.	Kn	Lbf.	Kn	Lbs.	Kg
ISS-100-450	550	2.447	450	205	5.5	2.5
ISS-500-1000	1250	567	1000	454	6.75	3.1

Dimension : ISS ISOTECH SEISMIC SNUBBER

Model	L1		W		H		R		A	
	in	mm	in	mm	in	mm	in	mm	in	mm
ISS-100-450	4 1/2	115	4	77	3 3/4	93	3/8	16	1 1/2	29
	L2		T		ØD					
	in	mm	in	mm	in	mm				
ISS-500-1000	6 3/4	172	3/8	10	5/8				16	
	L1		W		H		R		A	
	in	mm	in	mm	in	mm	in	mm	in	mm
ISS-500-1000	5	127	3 1/2	89	4 1/8	105	3/8	16	1 1/2	39
	L2		T		ØD					
	in	mm	in	mm	in	mm				
ISS-500-1000	8	204	3/8	10	3/4				20	
	L1		W		H		R		A	
	in	mm	in	mm	in	mm	in	mm	in	mm

ISOLATOR'S LOCATIONS

1:	5:
2:	6:
3:	7:
4:	8:

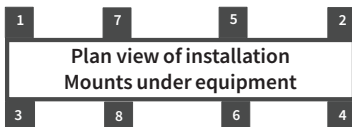

Notes:

- Seismic Snubbers are made of high yield/strength steel material and are designed for 1 g lateral force
- Seismic Snubbers have powder-coat finish to provide maximum corrosion resistance
- Seismic Load calculation must be performed to ensure proper selection of product

ISS-100-450

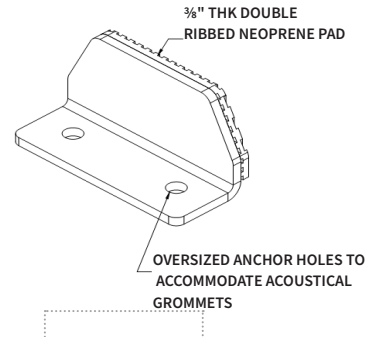

ISS-100-450

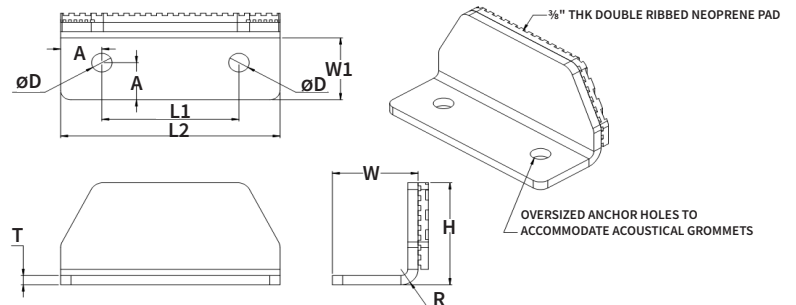

ISS-500-1000

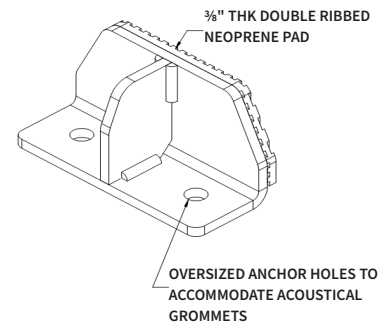

ISS-500-1000

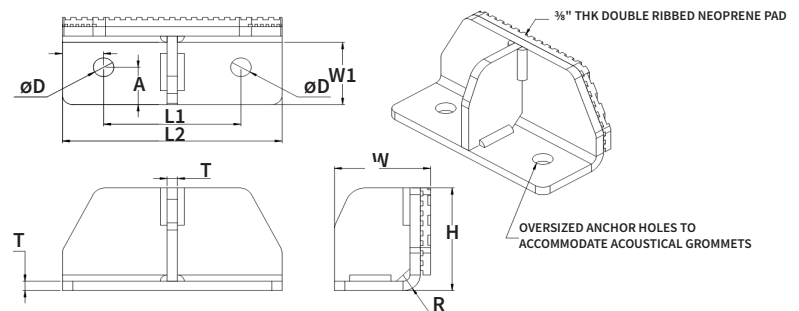

PROJECT INFORMATION		EQUIPMENT INFORMATION		Canada location	USA Location
Customer:		Type:		35 Siltan Road Woodbridge ON L4L 7Z8 CANADA T: 905-856-5001	3021 E Coronado St. Anaheim, CA.,92806 U.S.A T: 949-788-2930
Project:		Qty Required:			
Drawing No:		Operating Weight:			
Notes:				Tool free : 1-888-831-3311 www.isotechindustries.com	